



Kit Contents

	Description	Part No	Pcs
1	Shock absorber front	POS 5N21	2
2	Sleeve	24638-01	2
3	Dust boot	10216-02	2
4	Plastic spacer	25602-01	2
5	Spring	48000-19	2
6	Elastic spacer	25601-01	2
7	Upper spring adapter	06015-02	2
7	Spring platform M52	05018-11	2
8	Lock nut M52	00533-21	8
9	Anti roll bar bracket	25616-01	2
10	M14 lock nut	24627-04	2
11	Uniball top mount	05927-51	2
12	M6 screw	01046-06	2
13	Lubricating paste Molykote 1000	25715-01	1
14	Öhlins sticker kit	10207-01	2
15	C-spanner	00710-02	1
16	Öhlins owner manual		

👁 Note!

Please note that there can be small differences between your product and the images in these instructions.

👁 Note!

Please note that during storage and transport, especially at high ambient temperature, some of the oil and grease used for assembly may leak and stain the packaging. This will not cause damage to the product, wipe off the excessive oil or grease with a cloth.

👁 Note!

Before you install this product, check the kit contents. If anything is missing, please contact an Öhlins dealer.

⚠ Warning!

Before you install this product, read the Öhlins Owner's manual. This product is an important part of the vehicle and the vehicle stability.

Shock absorber for Porsche 911 Carrera 4/ Turbo (997)

POZ MW10 Front

Mounting Instructions



MOUNTING INSTRUCTIONS

⚠ Warning!

We strongly recommend to let an Öhlins dealer install this product.

⚠ Warning!

If you work with a lifted vehicle, make sure that it is safely supported to prevent it from tipping over.

👁 Note!

When you work with this product, see the vehicle service manual for vehicle specific procedures and important data.

👁 Note!

Before you install this product clean the vehicle.

1

Remove the original shock absorbers from the vehicle, see the vehicle service manual for correct procedure.

⚠ Warning!

The spring is preloaded so take precaution when you remove the spring from the shock absorber.

2

Cut the dust boot: 62 mm from the lower end according to Fig 2.

3

Assemble the strut/shock absorber, see figure 1.

4

Clean the top pin thread and nut with rubbing alcohol or brake cleaner. Apply the supplied grease on the top pin thread with a brush and on the bottom surface on the M14 nut.

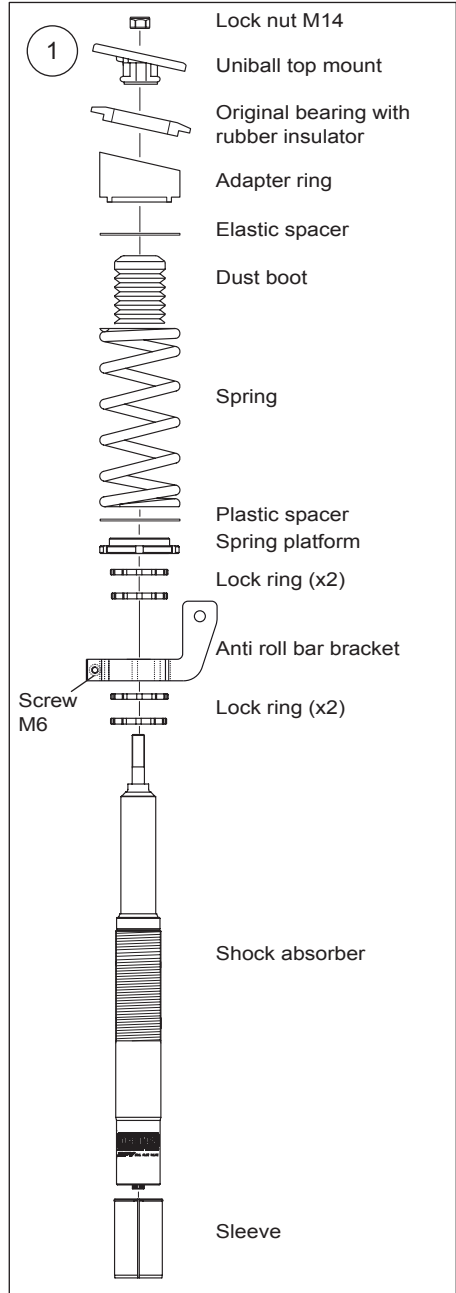
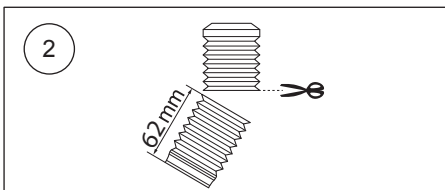

MOUNTING INSTRUCTIONS

5

Fit and tighten the M14 lock nut by 60 Nm (44 ftlb) and hold the strut steady with a 6 mm allen key. Make sure you rotate the nut and not the top pin!

⚠ Warning!

This torque is very important, make sure to use a torque wrench. See fig 5 on how to achieve correct torque when using an extension with your torque wrench. Tightening of the M14 lock nut MUST be performed before the strut is fitted on to the vehicle.

6

Set the installation dimensions according to figure 3. You may need to change these to reach the target height.

👁 Note!

After you have installed all shock absorbers/struts you must check and adjust height. See section Adjustments and Setup data.

7

Install the Öhlins strut on the vehicle according to the vehicle service manual. Tighten the 3 top mount nuts to 33Nm (24 ft-lb).

👉 Caution!

Ensure that all screws are tightened to the correct torque and that nothing fouls or restricts movement of the strut/shock absorber when the suspension is fully compressed or extended.

👁 Note!

Make sure that all removed parts, except the replaced parts, are reinstalled in the same positions as they were before the installation of the Öhlins shock absorbers.

8

Position the anti roll bar bracket, see figure 4.

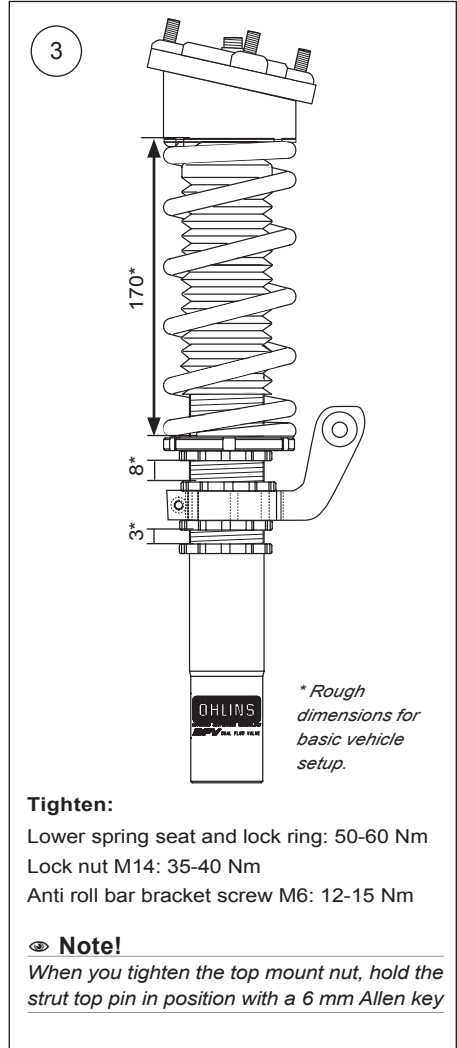
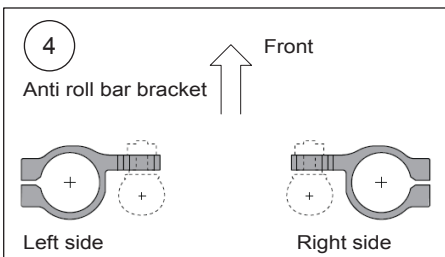

👁 Note!

When you tighten the top mount nut, hold the strut top pin in position with a 6 mm Allen key

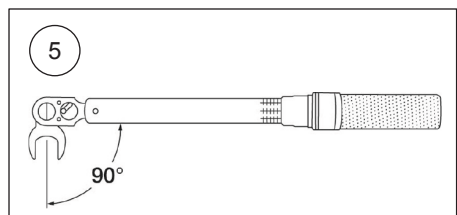

ADJUSTMENTS

⚠ Warning!

Before you drive, always make sure that the setup is according to the recommended setup data. Read about adjustments and setting up in the Öhlins Owner's Manual before you make any adjustments. Contact an Öhlins dealer if you have any questions about setting up.

👁 Note!

All dimensions are applicable for vehicles with original wheel dimensions.

Set vehicle height

When the Öhlins dampers are setup according to figure 5 and installed on the vehicle we recommend to set the height.

Definitions:

- A; Highest point on fender to ground.
- B; Highest point on fender to center of wheel.
- B'; Highest point of fender to lower edge of rim.
- D; Diameter of rim (measured)

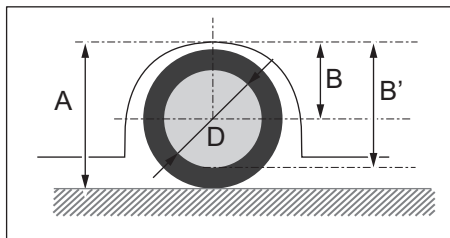

Actual vehicle height:

The target height (B) for your vehicle with the Öhlins dampers installed is:

- front: 338 mm
- rear: 345 mm

To calculate target height (B):

1. Measure the rim (D).
2. Measure from the lowest point of the fender to the lowest edge of the rim and subtract half the diameter of the rim (D).

$$B = B' - D/2$$

If the height needs to be adjusted to reach the target height, change the length of the damper with the lower lock ring on the front damper and by moving the golden cup on the rear damper.

👁 Note!

Do not adjust outside the recommended range. Tighten to the specified torque after you have adjusted.

SETUP DATA

Adjuster settings		
Track	0-7	clicks
Winding road	5-10	clicks
Street	10-20	clicks
Spring		
Free length	180	mm
Spring rate	70	N/mm
Spring preload	10	mm

Vehicle height

The height of the vehicle is set with the dampers on the car according to the instructions in the Owners Manual. The length of the front strut can be adjusted in the range between +10 mm (to raise) and -10 mm (to lower) from the reference length. +10 mm should be close to the original height of the front of the vehicle and -8 a lowering of approx 20 mm compared to the original car.

Öhlins products are subject to continuous improvement and development, therefore, although these instructions include the most up-to-date information available at the time of printing, minor updates may occur.

To find the latest information contact an Öhlins distributor. Please contact Öhlins if you have any questions regarding the contents in this document.

Part no. MI_POZMW10_0 front
Issued 2021-10-12

© Öhlins Racing AB. All rights reserved. Any reprinting or unauthorized use without the written permission of Öhlins Racing AB is prohibited.

Öhlins Racing AB
Box 722
S-194 27 Upplands Väsby, Sweden
Phone +46 8 590 025 00
fax +46 8 590 025 80



www.ohlins.com



Kit Contents

	Description	Part No	Pcs
1	Shock absorber rear	POS 6N20	2
2	Flange screw, M12x80	24628-06	2
3	Flange nut, M12	00139-04	2
4	Adapter ring		2
5	Spring platform M52	05018-11	2
6	Lock ring M52	00533-21	4
7	Elastic spacer	25601-01	2
8	Dust boot	10216-03	2
9	Spring	48010-39	2
10	Plastic spacer	25602-01	2
11	Lock nut M12	24627-02	2
12	12mm Washer	24619-03	2
13	Click adjuster	24631-02	2

👁 Note!

Please note that there can be small differences between your product and the images in these instructions.

👁 Note!

Please note that during storage and transport, especially at high ambient temperature, some of the oil and grease used for assembly may leak and stain the packaging. This will not cause damage to the product, wipe off the excessive oil or grease with a cloth.

👁 Note!

Before you install this product, check the kit contents. If anything is missing, please contact an Öhlins dealer.

⚠ Warning!

Before you install this product, read the Öhlins Owner's manual. This product is an important part of the vehicle and the vehicle stability.

Shock absorber for Porsche 911 Carrera 4/ Turbo (997)

POZ MW10 Rear

Mounting Instructions



MOUNTING INSTRUCTIONS

⚠ Warning!

We strongly recommend to let an Öhlins dealer install this product.

⚠ Warning!

If you work with a lifted vehicle, make sure that it is safely supported to prevent it from tipping over.

👁 Note!

When you work with this product, see the vehicle service manual for vehicle specific procedures and important data.

👁 Note!

Before you install this product clean the vehicle.

1

Remove the original shock absorbers from the vehicle, see the vehicle service manual for correct procedure.

2

Remove the:

- top washer
- top mount
- lower washer

from the original shock absorber. Note that you will need these parts to install the Öhlins shock absorber.

⚠ Warning!

The spring is preloaded so take precaution when you remove the spring from the shock absorber.

3

Cut the dust boot: 82 mm from the lower end.

4

Assemble the strut/shock absorber, see figure 1.

👁 Note!

Remove the golden colored cup before you install the spring seat and the lock nuts on the shock absorber.

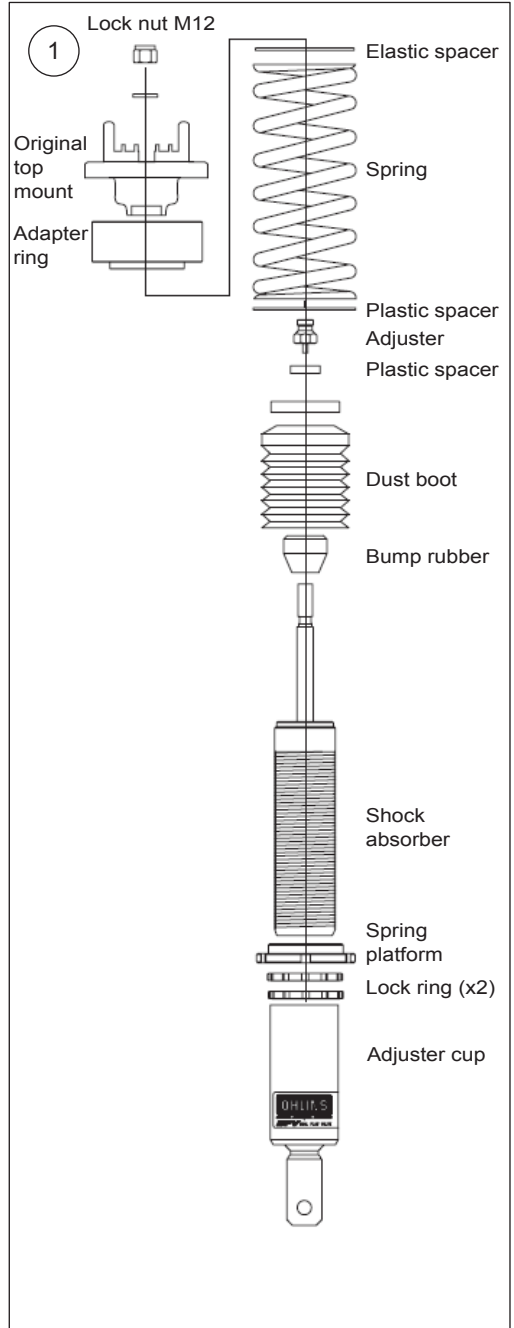
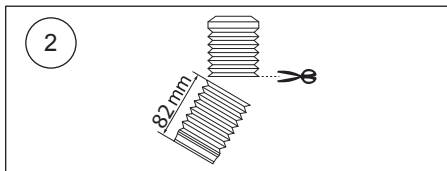

MOUNTING INSTRUCTIONS

5

Set the installation dimensions according to figure 3. You may need to change these to reach the target height.

6

Install the Öhlins shock absorber on the vehicle according to the vehicle service manual. Use the supplied M12 bolt and nut for the lower installation.

Caution!

Ensure that all screws are tightened to the correct torque and that nothing fouls or restricts movement of the strut/shock absorber when the suspension is fully compressed or extended.

Note!

Make sure that all removed parts, except the replaced parts, are reinstalled in the same positions as they were before the installation of the Öhlins shock absorbers.

7

If the car is equipped with the BOSE loud speaker system you will need a wire adjuster.

Part numbers:

24631-01 (1 pc/side)

24632-02 (1 pc/side)

24633-01 (1 pc/side)

24633-02 (1 pc/side)

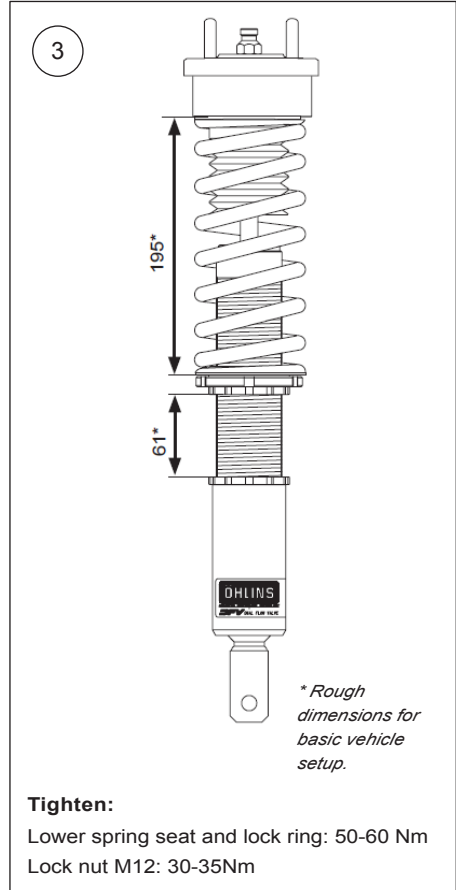

ADJUSTMENTS

⚠ Warning!

Before you drive, always make sure that the setup is according to the recommended setup data. Read about adjustments and setting up in the Öhlins Owner's Manual before you make any adjustments. Contact an Öhlins dealer if you have any questions about setting up.

👁 Note!

All dimensions are applicable for vehicles with original wheel dimensions.

Set vehicle height

When the Öhlins dampers are setup according to figure 5 and installed on the vehicle we recommend to set the height.

Definitions:

- A; Highest point on fender to ground.
- B; Highest point on fender to center of wheel.
- B'; Highest point of fender to lower edge of rim.
- D; Diameter of rim (measured)

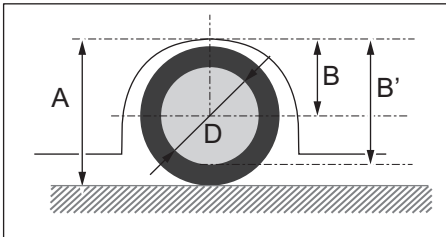

Actual vehicle height:

The target height (B) for your vehicle with the Öhlins dampers installed is:

- front: 345 mm
- rear: 350 mm

To calculate target height (B):

1. Measure the rim (D).
2. Measure from the lowest point of the fender to the lowest edge of the rim and subtract half the diameter of the rim (D).

$$B = B' - D/2$$

If the height needs to be adjusted to reach the target height, change the length of the damper with the lower lock ring on the front damper and by moving the golden cup on the rear damper.

👁 Note!

Do not adjust outside the recommended range. Tighten to the specified torque after you have adjusted.

SETUP DATA

Adjuster settings		
Track	0-7	clicks
Winding road	5-10	clicks
Street	10-20	clicks
Spring		
Free length	190-200	mm
Spring rate	120	N/mm
Spring preload	5	mm

Vehicle height

The height of the vehicle is set with the dampers on the car according to the instructions in the Owners Manual. The length of the rear shock absorber can be adjusted in the range between +10 mm (raise) and -10 mm (lowering) from the reference length. +10 mm should be close to the original height of rear of the vehicle and -10 a lowering of approx 25 mm compared to the original car.

Öhlins products are subject to continuous improvement and development, therefore, although these instructions include the most up-to-date information available at the time of printing, minor updates may occur.

To find the latest information contact an Öhlins distributor. Please contact Öhlins if you have any questions regarding the contents in this document.

Part no. MI_POZMW10_0 rear
Issued 2021-10-12

© Öhlins Racing AB. All rights reserved. Any reprinting or unauthorized use without the written permission of Öhlins Racing AB is prohibited.

Öhlins Racing AB
Box 722
S-194 27 Upplands Väsby, Sweden
Phone +46 8 590 025 00
fax +46 8 590 025 80



www.ohlins.com